

## Installing the Flight Deck TOUR into the BASE.

First, lay your BASE down on the desired Indoor Putting area and flat to the ground. If you are using a strip style putting green that is less than the width of the BASE, place a kitchen or yoga mat underneath the BASE to level it to the same height as the putting strip green.

Next, follow the illustration below:

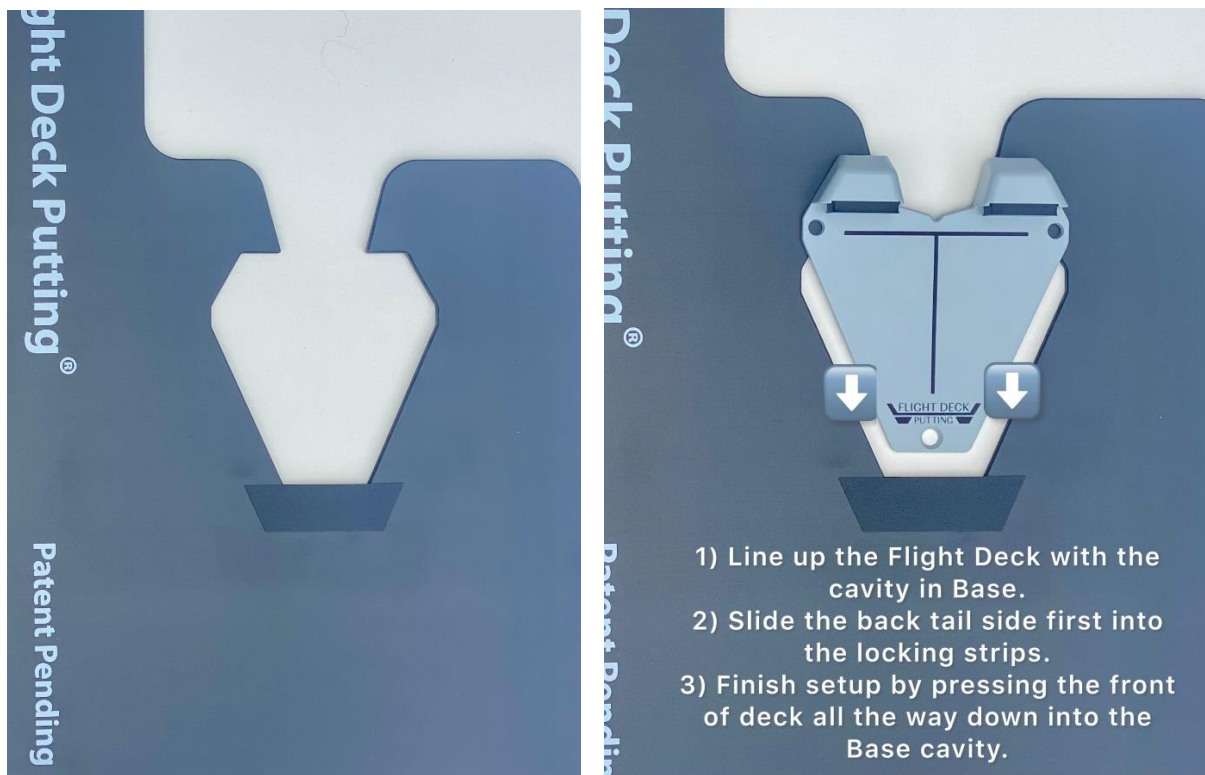

To remove Deck, lift front side up, then carefully slide out the rear tail piece from the locking strips.

**IMPORTANT!** THE BASE IS DESIGNED FOR **INDOOR USE ONLY!** DO NOT EXPOSE TO DIRECT SUNLIGHT OR HEAT! THIS CAN CAUSE THE BASE TO WARP.